

© All rights reserved. No part of this publication may be reproduced, stored in a retrieval system, or transmitted, in any form or by any means, electronic, mechanical, photocopying, recording, or by any information storage and retrieval system, without the prior written permission of the copyright owner.

THIS DRAWING IS COPYRIGHTED
 This drawing is the property of Mawson Kerr Architects.

NO.	DATE	DESCRIPTION	BY
01	10/10/20	Issue for Client Approval	AK
02	10/10/20	Issue for Client Approval	AK
03	10/10/20	Issue for Client Approval	AK

REVISIONS



Proposed East Elevation
 1:100

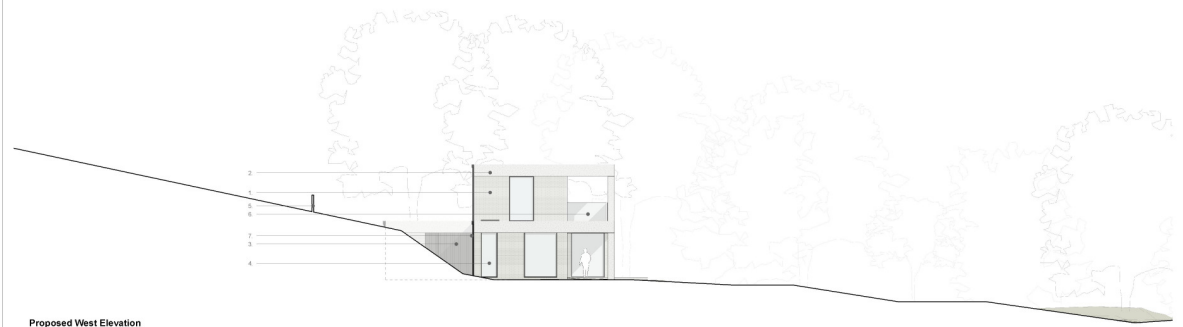

Proposed West Elevation
 1:100

- KEY
- 1. Light Brick
- 2. Stone / Cast Stone
- 3. Darkened Timber
- 4. High Performance Glazing
- 5. Timber post and rail fence
- 6. Glass balustrade
- 7. Aluminium rain water goods

mawsonkerr
 ARCHITECTS

Project	2104
Client	Mrs and Mrs Weston
Location	ALBERT
Scale	1:100
Drawn	AK
Checked	AK
Date	OCT 20 20

All drawings to be submitted to the
 Queensland Planning and Environment Department
 and the Queensland Building and Construction
 Commission (QBCC) for approval.

THE DRAWING IS COPYRIGHT
 THE DRAWING IS NOT TO BE REPRODUCED OR
 TRANSMITTED IN ANY FORM OR BY ANY MEANS
 WITHOUT THE WRITTEN PERMISSION OF
 MAWSONKERR ARCHITECTS.

NO.	DATE	DESCRIPTION	BY	CHECKED
01	10/10/20	Issue for Approval	AL	AL
02	10/10/20	Issue for Approval	AL	AL
03	10/10/20	Issue for Approval	AL	AL
04	10/10/20	Issue for Approval	AL	AL
05	10/10/20	Issue for Approval	AL	AL
06	10/10/20	Issue for Approval	AL	AL
07	10/10/20	Issue for Approval	AL	AL
08	10/10/20	Issue for Approval	AL	AL
09	10/10/20	Issue for Approval	AL	AL
10	10/10/20	Issue for Approval	AL	AL
11	10/10/20	Issue for Approval	AL	AL
12	10/10/20	Issue for Approval	AL	AL
13	10/10/20	Issue for Approval	AL	AL
14	10/10/20	Issue for Approval	AL	AL
15	10/10/20	Issue for Approval	AL	AL
16	10/10/20	Issue for Approval	AL	AL
17	10/10/20	Issue for Approval	AL	AL
18	10/10/20	Issue for Approval	AL	AL
19	10/10/20	Issue for Approval	AL	AL
20	10/10/20	Issue for Approval	AL	AL

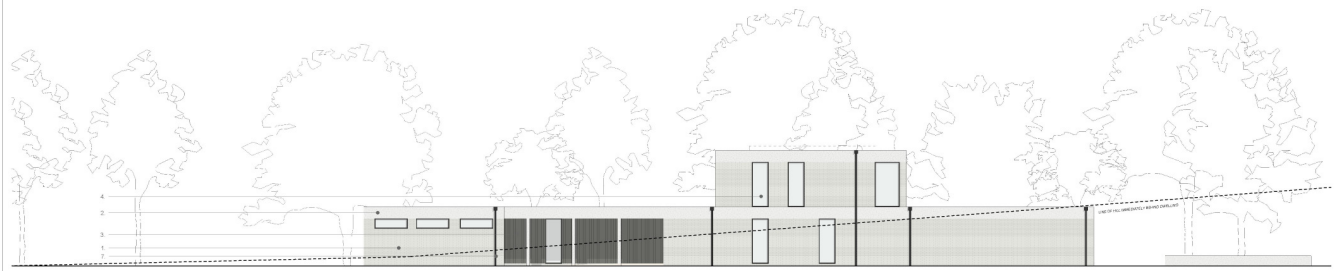

Proposed North Elevation
1:100



Proposed South Elevation
1:100

KEY

1.	Light Brick
2.	Stone / Cast Stone
3.	Darkened Timber
4.	High Performance Glazing
5.	Timber post and rail fence
6.	Glass balustrade
7.	Aluminium rain-water goods

mawsonkerr

170 Wickham Street, Brisbane QLD 4000
 Telephone: (07) 3254 1234
 Email: info@mawsonkerr.com.au

Project	2104
Client	M and Mrs Weston
Project Name	Proposed North and South Elevations
Project No.	AL030
Scale	1:100
Author	AL
Check	OC
Date	OCT 20 20

All dimensions are in millimeters unless otherwise stated. All dimensions are to the centerline of the building unless otherwise stated. All dimensions are to the centerline of the building unless otherwise stated. All dimensions are to the centerline of the building unless otherwise stated.

NO.	REVISION	DATE
1	ISSUED FOR PERMIT	2024/10/20
2	ISSUED FOR PERMIT	2024/10/20
3	ISSUED FOR PERMIT	2024/10/20



mawsonkerr
 Chartered Architectural Firm
 100/102/104/106/108/110/112/114/116/118/120/122/124/126/128/130/132/134/136/138/140/142/144/146/148/150/152/154/156/158/160/162/164/166/168/170/172/174/176/178/180/182/184/186/188/190/192/194/196/198/200/202/204/206/208/210/212/214/216/218/220/222/224/226/228/230/232/234/236/238/240/242/244/246/248/250/252/254/256/258/260/262/264/266/268/270/272/274/276/278/280/282/284/286/288/290/292/294/296/298/300/302/304/306/308/310/312/314/316/318/320/322/324/326/328/330/332/334/336/338/340/342/344/346/348/350/352/354/356/358/360/362/364/366/368/370/372/374/376/378/380/382/384/386/388/390/392/394/396/398/400/402/404/406/408/410/412/414/416/418/420/422/424/426/428/430/432/434/436/438/440/442/444/446/448/450/452/454/456/458/460/462/464/466/468/470/472/474/476/478/480/482/484/486/488/490/492/494/496/498/500/502/504/506/508/510/512/514/516/518/520/522/524/526/528/530/532/534/536/538/540/542/544/546/548/550/552/554/556/558/560/562/564/566/568/570/572/574/576/578/580/582/584/586/588/590/592/594/596/598/600/602/604/606/608/610/612/614/616/618/620/622/624/626/628/630/632/634/636/638/640/642/644/646/648/650/652/654/656/658/660/662/664/666/668/670/672/674/676/678/680/682/684/686/688/690/692/694/696/698/700/702/704/706/708/710/712/714/716/718/720/722/724/726/728/730/732/734/736/738/740/742/744/746/748/750/752/754/756/758/760/762/764/766/768/770/772/774/776/778/780/782/784/786/788/790/792/794/796/798/800/802/804/806/808/810/812/814/816/818/820/822/824/826/828/830/832/834/836/838/840/842/844/846/848/850/852/854/856/858/860/862/864/866/868/870/872/874/876/878/880/882/884/886/888/890/892/894/896/898/900/902/904/906/908/910/912/914/916/918/920/922/924/926/928/930/932/934/936/938/940/942/944/946/948/950/952/954/956/958/960/962/964/966/968/970/972/974/976/978/980/982/984/986/988/990/992/994/996/998/1000

Project	2104
Client	M and Mrs Weston
Proposed First Floor Plan	AL/EGZ
Scale	1:100
Drawn	AY
Checked	OC
Date	OCT 20 24

Proposed First Floor Plan
 1:100



All drawings to be submitted to the
 Department of Building and Fire Services for approval and to be signed and
 sealed by a registered professional engineer or architect. THIS DRAWING IS COPYRIGHT
 © THE DRAWING & DESIGN GROUP
 This drawing is to be used in accordance with the drawings.

NO.	DATE	DESCRIPTION	BY	CHECKED
01	10/09/20	Issue for approval	AL	AL
02	10/09/20	Issue for approval	AL	AL
03	10/09/20	Issue for approval	AL	AL
04	10/09/20	Issue for approval	AL	AL
05	10/09/20	Issue for approval	AL	AL
06	10/09/20	Issue for approval	AL	AL
07	10/09/20	Issue for approval	AL	AL
08	10/09/20	Issue for approval	AL	AL
09	10/09/20	Issue for approval	AL	AL
10	10/09/20	Issue for approval	AL	AL
11	10/09/20	Issue for approval	AL	AL
12	10/09/20	Issue for approval	AL	AL
13	10/09/20	Issue for approval	AL	AL
14	10/09/20	Issue for approval	AL	AL
15	10/09/20	Issue for approval	AL	AL
16	10/09/20	Issue for approval	AL	AL
17	10/09/20	Issue for approval	AL	AL
18	10/09/20	Issue for approval	AL	AL
19	10/09/20	Issue for approval	AL	AL
20	10/09/20	Issue for approval	AL	AL
21	10/09/20	Issue for approval	AL	AL
22	10/09/20	Issue for approval	AL	AL
23	10/09/20	Issue for approval	AL	AL
24	10/09/20	Issue for approval	AL	AL
25	10/09/20	Issue for approval	AL	AL
26	10/09/20	Issue for approval	AL	AL
27	10/09/20	Issue for approval	AL	AL
28	10/09/20	Issue for approval	AL	AL
29	10/09/20	Issue for approval	AL	AL
30	10/09/20	Issue for approval	AL	AL
31	10/09/20	Issue for approval	AL	AL
32	10/09/20	Issue for approval	AL	AL
33	10/09/20	Issue for approval	AL	AL
34	10/09/20	Issue for approval	AL	AL
35	10/09/20	Issue for approval	AL	AL
36	10/09/20	Issue for approval	AL	AL
37	10/09/20	Issue for approval	AL	AL
38	10/09/20	Issue for approval	AL	AL
39	10/09/20	Issue for approval	AL	AL
40	10/09/20	Issue for approval	AL	AL
41	10/09/20	Issue for approval	AL	AL
42	10/09/20	Issue for approval	AL	AL
43	10/09/20	Issue for approval	AL	AL
44	10/09/20	Issue for approval	AL	AL
45	10/09/20	Issue for approval	AL	AL
46	10/09/20	Issue for approval	AL	AL
47	10/09/20	Issue for approval	AL	AL
48	10/09/20	Issue for approval	AL	AL
49	10/09/20	Issue for approval	AL	AL
50	10/09/20	Issue for approval	AL	AL
51	10/09/20	Issue for approval	AL	AL
52	10/09/20	Issue for approval	AL	AL
53	10/09/20	Issue for approval	AL	AL
54	10/09/20	Issue for approval	AL	AL
55	10/09/20	Issue for approval	AL	AL
56	10/09/20	Issue for approval	AL	AL
57	10/09/20	Issue for approval	AL	AL
58	10/09/20	Issue for approval	AL	AL
59	10/09/20	Issue for approval	AL	AL
60	10/09/20	Issue for approval	AL	AL
61	10/09/20	Issue for approval	AL	AL
62	10/09/20	Issue for approval	AL	AL
63	10/09/20	Issue for approval	AL	AL
64	10/09/20	Issue for approval	AL	AL
65	10/09/20	Issue for approval	AL	AL
66	10/09/20	Issue for approval	AL	AL
67	10/09/20	Issue for approval	AL	AL
68	10/09/20	Issue for approval	AL	AL
69	10/09/20	Issue for approval	AL	AL
70	10/09/20	Issue for approval	AL	AL
71	10/09/20	Issue for approval	AL	AL
72	10/09/20	Issue for approval	AL	AL
73	10/09/20	Issue for approval	AL	AL
74	10/09/20	Issue for approval	AL	AL
75	10/09/20	Issue for approval	AL	AL
76	10/09/20	Issue for approval	AL	AL
77	10/09/20	Issue for approval	AL	AL
78	10/09/20	Issue for approval	AL	AL
79	10/09/20	Issue for approval	AL	AL
80	10/09/20	Issue for approval	AL	AL
81	10/09/20	Issue for approval	AL	AL
82	10/09/20	Issue for approval	AL	AL
83	10/09/20	Issue for approval	AL	AL
84	10/09/20	Issue for approval	AL	AL
85	10/09/20	Issue for approval	AL	AL
86	10/09/20	Issue for approval	AL	AL
87	10/09/20	Issue for approval	AL	AL
88	10/09/20	Issue for approval	AL	AL
89	10/09/20	Issue for approval	AL	AL
90	10/09/20	Issue for approval	AL	AL
91	10/09/20	Issue for approval	AL	AL
92	10/09/20	Issue for approval	AL	AL
93	10/09/20	Issue for approval	AL	AL
94	10/09/20	Issue for approval	AL	AL
95	10/09/20	Issue for approval	AL	AL
96	10/09/20	Issue for approval	AL	AL
97	10/09/20	Issue for approval	AL	AL
98	10/09/20	Issue for approval	AL	AL
99	10/09/20	Issue for approval	AL	AL
100	10/09/20	Issue for approval	AL	AL

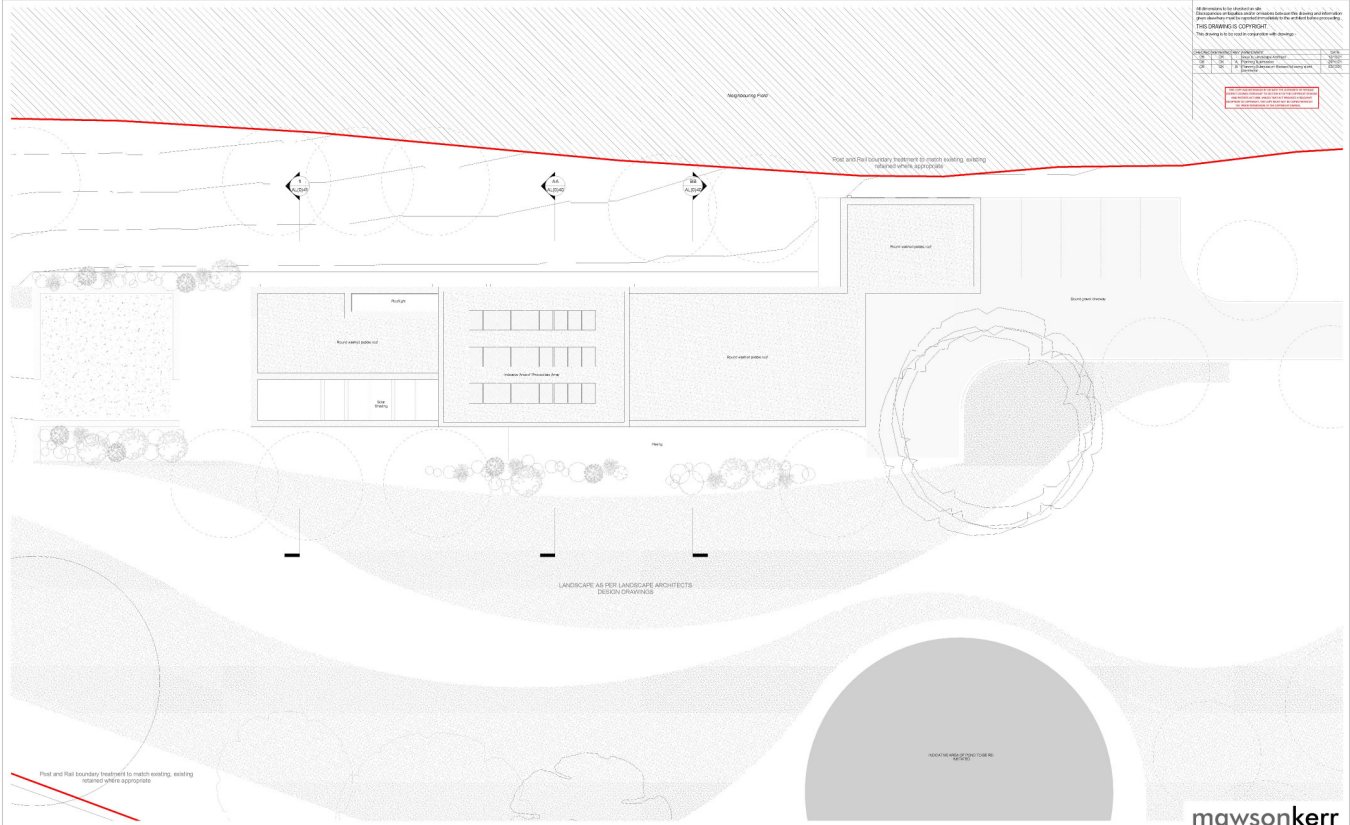

LANDSCAPE AS PER LANDSCAPE ARCHITECTS DESIGN DRAWINGS

mawsonkerr

PROJECT			
Project	2104		
Client	M and Mrs Weston		
Proposed Roof Plan	AL/EGG		
REVISIONS			
NO.	DATE	BY	CHKD
1	10/09/20	AL	AL
2	10/09/20	AL	AL
3	10/09/20	AL	AL
4	10/09/20	AL	AL
5	10/09/20	AL	AL
6	10/09/20	AL	AL
7	10/09/20	AL	AL
8	10/09/20	AL	AL
9	10/09/20	AL	AL
10	10/09/20	AL	AL
11	10/09/20	AL	AL
12	10/09/20	AL	AL
13	10/09/20	AL	AL
14	10/09/20	AL	AL
15	10/09/20	AL	AL
16	10/09/20	AL	AL
17	10/09/20	AL	AL
18	10/09/20	AL	AL
19	10/09/20	AL	AL
20	10/09/20	AL	AL
21	10/09/20	AL	AL
22	10/09/20	AL	AL
23	10/09/20	AL	AL
24	10/09/20	AL	AL
25	10/09/20	AL	AL
26	10/09/20	AL	AL
27	10/09/20	AL	AL
28	10/09/20	AL	AL
29	10/09/20	AL	AL
30	10/09/20	AL	AL
31	10/09/20	AL	AL
32	10/09/20	AL	AL
33	10/09/20	AL	AL
34	10/09/20	AL	AL
35	10/09/20	AL	AL
36	10/09/20	AL	AL
37	10/09/20	AL	AL
38	10/09/20	AL	AL
39	10/09/20	AL	AL
40	10/09/20	AL	AL
41	10/09/20	AL	AL
42	10/09/20	AL	AL
43	10/09/20	AL	AL
44	10/09/20	AL	AL
45	10/09/20	AL	AL
46	10/09/20	AL	AL
47	10/09/20	AL	AL
48	10/09/20	AL	AL
49	10/09/20	AL	AL
50	10/09/20	AL	AL
51	10/09/20	AL	AL
52	10/09/20	AL	AL
53	10/09/20	AL	AL
54	10/09/20	AL	AL
55	10/09/20	AL	AL
56	10/09/20	AL	AL
57	10/09/20	AL	AL
58	10/09/20	AL	AL
59	10/09/20	AL	AL
60	10/09/20	AL	AL
61	10/09/20	AL	AL
62	10/09/20	AL	AL
63	10/09/20	AL	AL
64	10/09/20	AL	AL
65	10/09/20	AL	AL
66	10/09/20	AL	AL
67	10/09/20	AL	AL
68	10/09/20	AL	AL
69	10/09/20	AL	AL
70	10/09/20	AL	AL
71	10/09/20	AL	AL
72	10/09/20	AL	AL
73	10/09/20	AL	AL
74	10/09/20	AL	AL
75	10/09/20	AL	AL
76	10/09/20	AL	AL
77	10/09/20	AL	AL
78	10/09/20	AL	AL
79	10/09/20	AL	AL
80	10/09/20	AL	AL
81	10/09/20	AL	AL
82	10/09/20	AL	AL
83	10/09/20	AL	AL
84	10/09/20	AL	AL
85	10/09/20	AL	AL
86	10/09/20	AL	AL
87	10/09/20	AL	AL
88	10/09/20	AL	AL
89	10/09/20	AL	AL
90	10/09/20	AL	AL
91	10/09/20	AL	AL
92	10/09/20	AL	AL
93	10/09/20	AL	AL
94	10/09/20	AL	AL
95	10/09/20	AL	AL
96	10/09/20	AL	AL
97	10/09/20	AL	AL
98	10/09/20	AL	AL
99	10/09/20	AL	AL
100	10/09/20	AL	AL

Proposed Roof Plan



